

FLORIDA DEPARTMENT OF NATURAL RESOURCES

CERTIFIED CORNER RECORD

CORNER DESCRIPTION:

N.W. corner of Section 18, Township 1 NORTH, Range 9 EAST; Tallahassee Base and Meridian; MADISON County(s), Florida

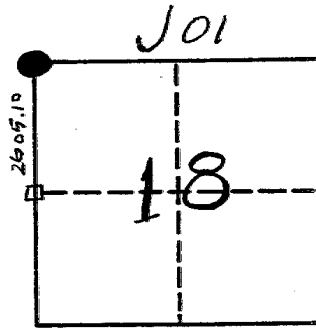

CORNER MONUMENT

Description of original monument and accessories and subsequent restoration. Give sources of information

J.W. DRAKE in 1825 - BEGINNING at the SE. CORNER of T 1 N, R 8 E (p. 179) AND RUNNING NORTH. 4th mile post calls for 4 pines @ EDGE of POND. ✓

MONUMENT DESCRIPTION:

Description of corner evidence found:

FOUND 4"x4" CONCRETE MONUMENT by J.W. WADSWORTH, RLS.

Description of corner evidence set:

TOOK TREES SEPT. 5, 1984

Florida State Plane Coordinates of Corner (if determined):

x: \_\_\_\_\_ y: \_\_\_\_\_ Zone: \_\_\_\_\_

Basis for coordinates:

RECEIVED

JAN 11 1985

SKETCH

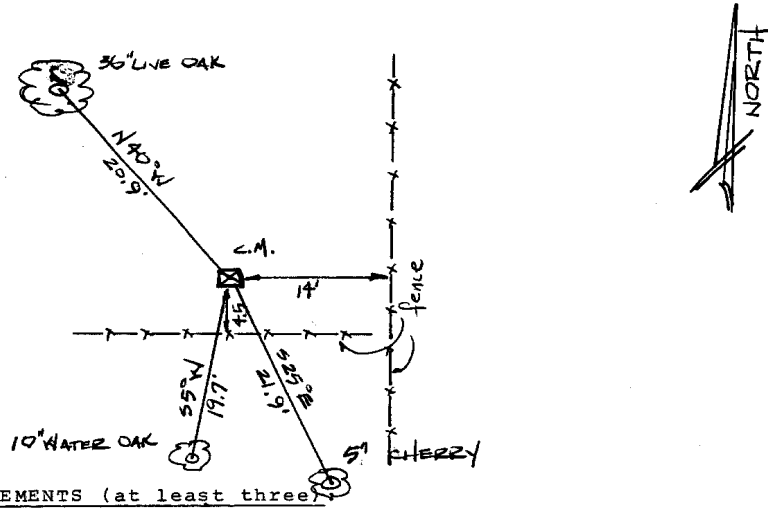

REFERENCE MEASUREMENTS (at least three)

| Description    | Distance |        | Bearing<br>(Give Basis) |
|----------------|----------|--------|-------------------------|
|                | feet     | metres |                         |
| 36" LIVE OAK   | 20.9'    |        | N 40° W                 |
| 5" CHERRY      | 21.9'    |        | S 25° E                 |
| 10" WATER OAK  | 19.7'    |        | S 5° W                  |
| FENCE CORNER : | 14'      |        | EAST                    |
|                | 4.5'     |        | SOUTH                   |

STATEMENT OF METHOD TO DETERMINE CORNER LOCATION (lost corners only)

THIS CORNER IS SHOWN ON 1957 TUSHBANK PLAT BY J.W. WADSWORTH RLS

SURVEYORS CERTIFICATE: This is to certify that the monument and accessories indicated above are correctly described and shown as they were on Oct 84 to the best of my knowledge and ability.

J. W. Scruggs  
Signature  
POB 121  
Firm or Agency  
Madison Fl  
Address  
32340

963  
Registration No.  
10 Jan 95  
Date

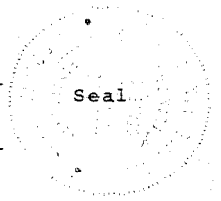

Checked By: S.S.  
Accepted and Filed: 11/5/85  
Date

Kevin B. Gault  
State Cadastral Surveyor